

Now !! Actually Affordable 2 BHK Flats in Revati Nagar, Besa.

Five  
**ELEMENTS**

*Jal*





# Five ELEMENTS

*Jal*



TYPICAL FLOOR PLAN



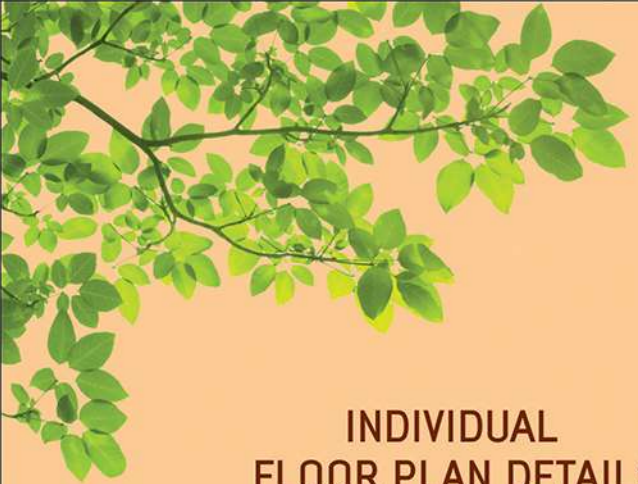

### INDIVIDUAL FLOOR PLAN DETAILS



TYPICAL FLOOR PLAN



TYPICAL FLOOR PLAN

# Five ELEMENTS *Jal*



Images used for representation purpose only.

## GROUND FLOOR PLAN



## ISOMETRIC VIEW

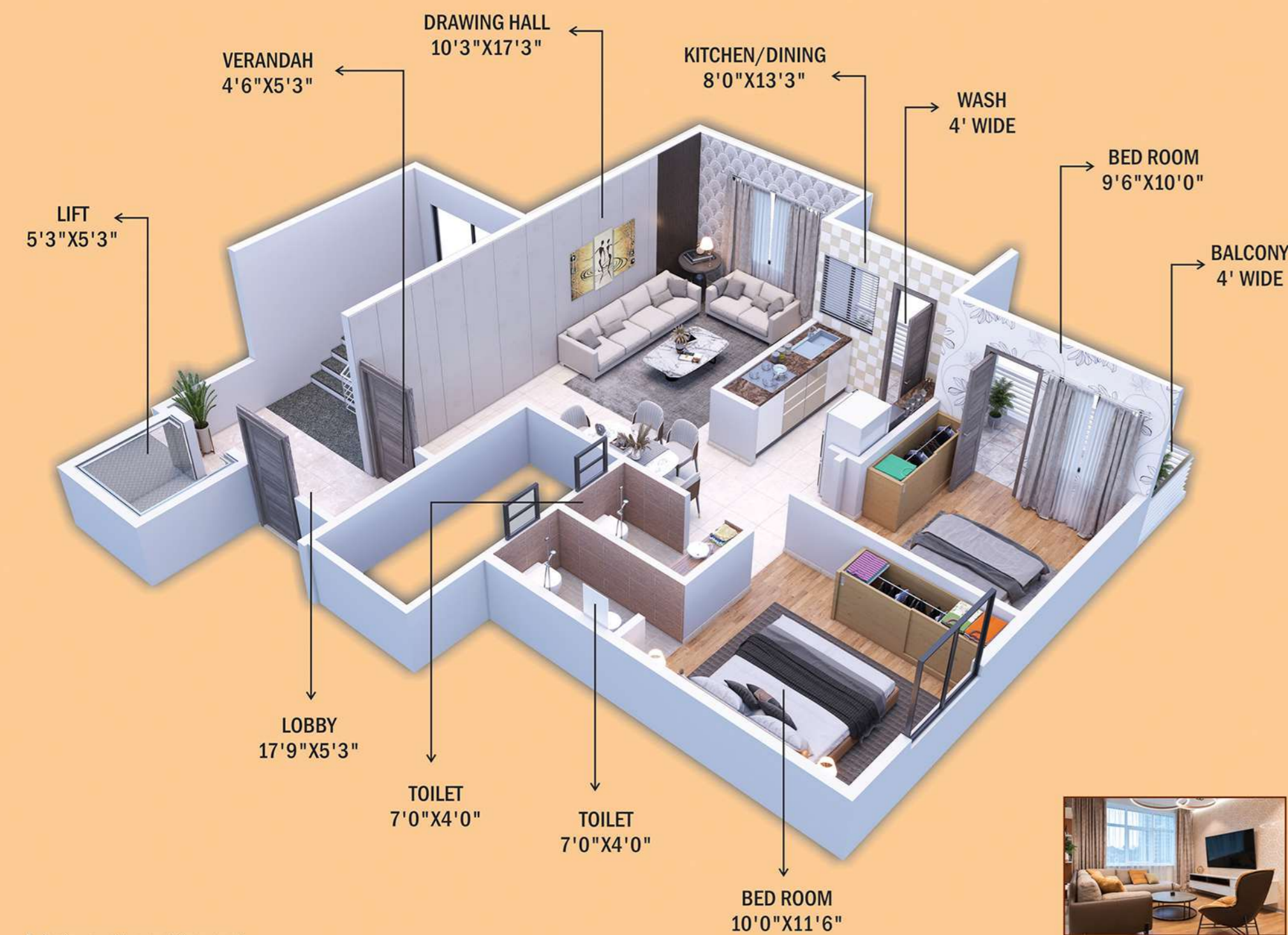

## ISOMETRIC VIEW

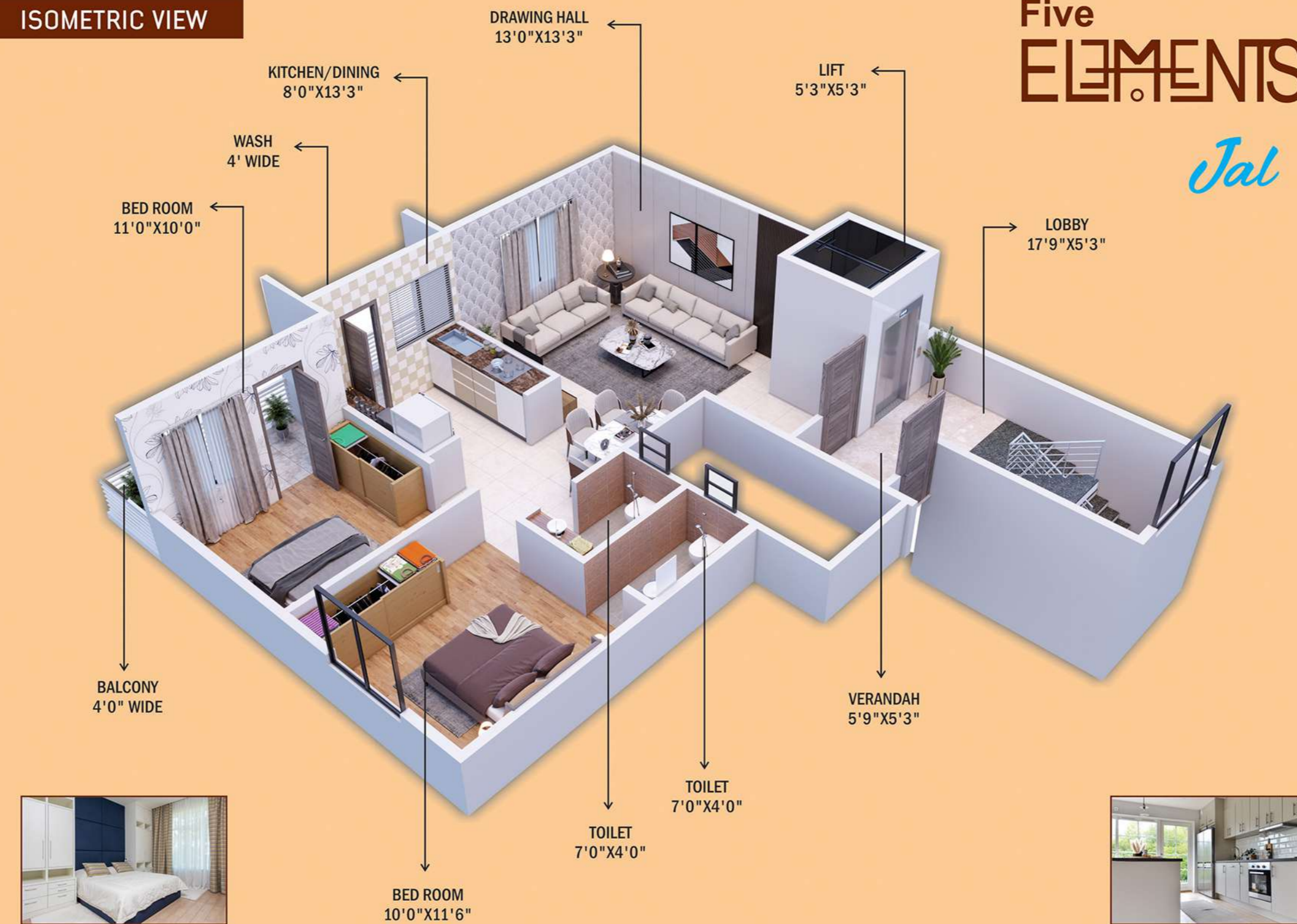

# Five ELEMENTS

## Jal

- **STRUCTURE**  
R.C.C. frame structure.
- **WALLS**  
External walls 150 mm thick & Internal walls 115 mm thick.
- **PLASTER**  
Internal smooth funny plaster & External double coated sand faced cement plaster.
- **PAINTING**  
Two coats of putting in all inside walls to get smooth surface for paints of selected sheds. Acrylic external paints to all external surface. Oil paints to all inside. Surface of doors & MS grills.
- **DOORS**  
Main door in Teakwood frame with flush panel & other door of concrete frame with flush panel.
- **WINDOWS**  
Fully glazed aluminum windows & M.S. grill with powder coating.
- **FLOORING**  
Vitrified tiles flooring in all rooms & Ips in parking.
- **KITCHEN**  
Black granite platform & stainless steel sink with modular kitchen.
- **ELECTRICAL**  
Adequate power point for fridge, mixer, oven etc. AC point in master bedroom. Modular switches of standard make. Provision for common lighting in staircase/passage and still parking.
- **PLUMBING**  
Standard CP fitting. All sewer line in PVC & GI pipes.
- **POP**  
POP ceiling to all rooms excluding kitchen.
- **STAIRCASE**  
Granite stone on tread & riser with S.S. hand railing.
- **TOILET**  
Glazed tiles with full height dado.
- **GATE**  
2 No. MS gate for entrance to the building.
- **BATH/TOILET**  
Hot & cold water mixer in toilets, wash basin & commode of matching colours with tiles and provision for geyser & exhaust fan.
- **WATER**  
Water supply through Maharashtra Jevan (MJP) Pradhikaran & Bore-well.

## SPECIFICATIONS

## AMENITIES



24 X 7 CCTV SURVEILLANCE



FAST AUTOMATIC LIFT WITH BACK UP

WATER BODY WITH MUSICAL FOUNTAIN

SMART MODULAR KITCHEN



COMPLETE POP IN ALL ROOMS

VIDEO DOOR PHONE \*

JAQUAR PLUMBING BATH FITTING\*



E.V. CHARGING POINT IN PARKING\*

TREES PLANTATIONS ALL AROUND THE PERIPHERAL

OPEN GYM ON TERRACE\*

- **TERMS & CONDITIONS**  
Stamp duty, GST & any other taxes, registration charges to be borne by the purchaser. Any additional work other than specification will be charged and should be paid in advance by the purchaser. M.S.E.B meter deposit, transformer deposit, water meter deposit & other related expenses at actual to be paid extra. CCTV, Jogging Path, Lawn

A PROJECT BY

**LOKESH ASSOCIATES**

CONTACT FOR BOOKING

9371457763

ARCHITECT

Ar. Mahesh Padole

LEGAL ADVISOR

Adv. Pavan G. Dhimole

Adv. Sarang D. Nighot

STRUCTURAL CONSULTANT

Sudesh Malode

MARKETED BY

## PRIME LOCATION PLAN

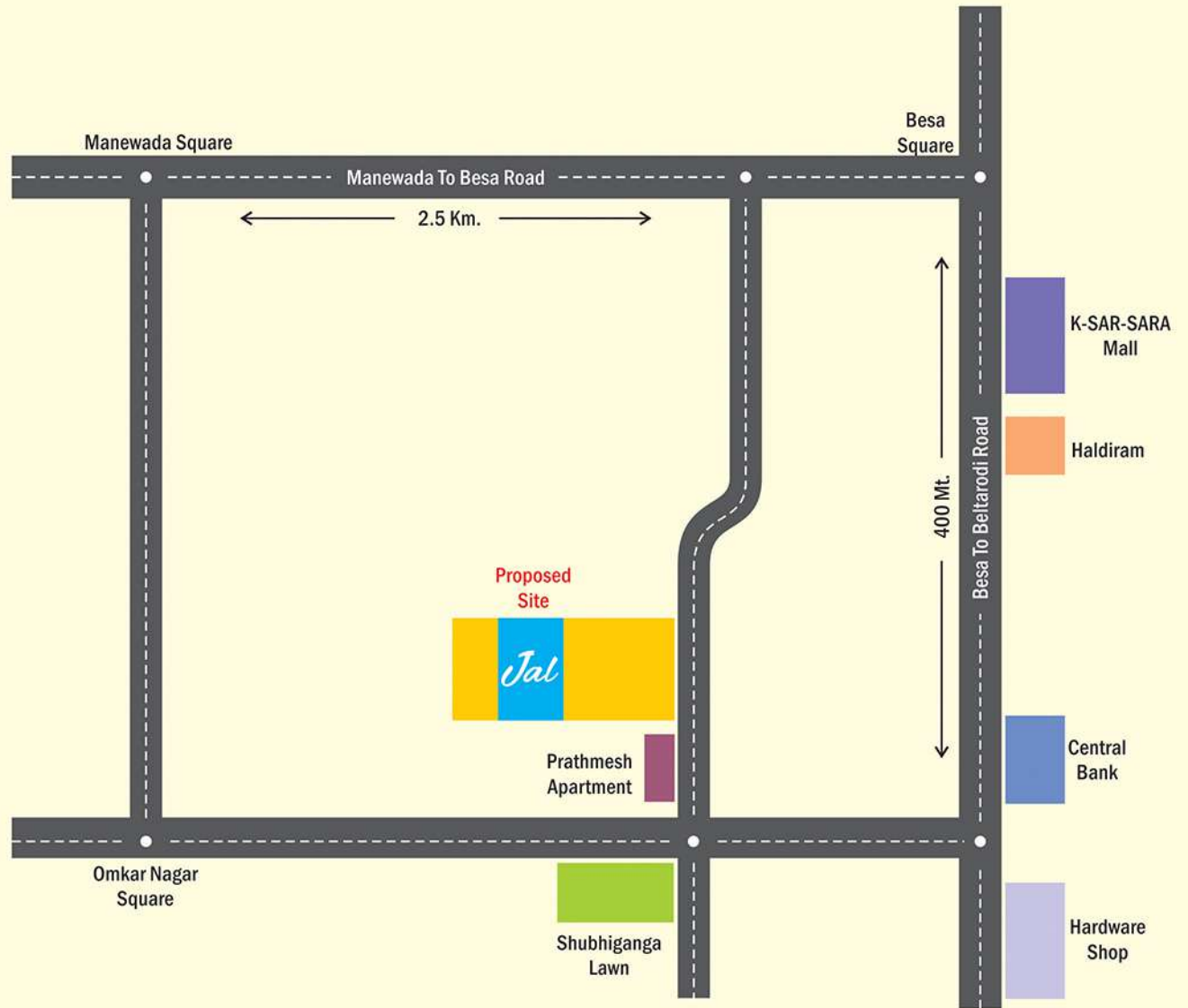

**SITE ADDRESS : KH. No. 58/1, Mouza - Besa, Plot No. 3 & 4,  
Jawahar Society, Revati Nagar, Besa, Nagpur - 440037.**



MAHA RERA REGISTRATION NO.

<http://maharera.mahaonline.gov.in>

This brochure is purely a conceptual presentation and not a legal offering. The promoters reserve the right to alter or make Any changes in the elevation, plans or specifications as deemed fit.